

## Variable frequency drive

### Applications

Assembled on a pump, booster set or installed on the wall, adjust the speed automatically to maintain the constant pressure and flow that apartment, building or installation demands at every moment.

### Materials

Body in aluminium.  
Front cover in technopolymer.

### Equipment and features

IPX5 protection.  
Maximum ambient temperature 40 °C.  
Air cooled motor.  
Maximum 4 pumps.  
USB port for updating the device's firmware.  
Adjustable working frequency.  
Inputs:  
- 1 analogue 4-20mA with 24V DC power supply.  
- 1 digital for the level switch.  
Outputs:  
- 1 alarm signal.  
- Potential-free output (FVC), maximum 1A, NA/NC contacts.  
Communication serial port RS 485.  
M22 with 2m of cable with plug type F.  
T22 and T55 no cable.



### Protections

Dry-run protection with automatic reset.  
Detection of pressure transducer failure.  
Overcurrent and short-circuit with automatic reset.  
Power supply voltage with automatic reset.  
Internal overtemperature with automatic reset.  
Earthing and motor phase error.  
Communication error.



Pressure transducer\*

Device for digital pressure reading

### Features table

Model	Input				Output				Code
	Power source voltage [V]	Power frequency [Hz]	Maximum motor current [A]	Recommended line protection [A]	Maximum motor power [kW]	Maximum motor current [A]	Motor voltage [V]	Motor frequency [Hz]	
Speedrive V2 M22	1~ 220V	50/60	16	25	2,2	10	3~ 220V	50/60	203323
Speedrive V2 T22	3~ 440V	50/60	7	10	2,2	6	3~ 440V	50/60	205490
Speedrive V2 T55	3~ 440V	50/60	15	20	5,5	14	3~ 440V	50/60	203321

Accessories	Code
Pressure transducer 4- 20 mA 1/4 G 10 bar	176579
Wall installation kit	209380
PCBA Modbus circuit	214754

### Dimension and weight

Model	A	B	C	D	Kg
Speedrive V2 M22	178	71	207	207	3,4
Speedrive V2 T22	142	85	207	207	2,7
Speedrive V2 T55	142	85	207	207	2,7

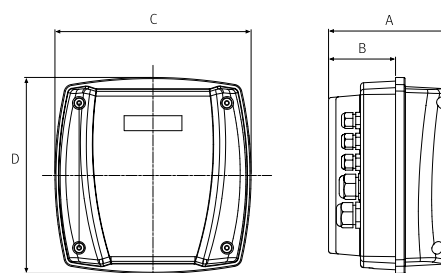

\*Pressure transducer is required for operation.